

NOTICE!!

These documents have been scanned!

Do not place un-scanned documents beneath this notice!

Do not remove this notice from this file!

GPO Jacket No. 560-102
Print Order 61540
Rise Business Services, LLC
Job=AZ15 5/2/2019



Box Number= AZ15019



Claim Begin-End: AMC437067-AMC437067

1 Initial Receipt



AZ15019-14

AMC436731-AMC437154

AMC#

DATE CLOSED

REMARKS

437067

AMC#	DATE CLOSED	REMARKS
437067		

**United States Department of the Interior
Bureau of Land Management**

LANDS/RECREATION & PLANNING
ONE N CENTRAL AVE
PHOENIX, AZ 85004 -2203
Phone: 602-417-9200

Receipt

No: 3505454

Transaction #: 3606534	
Date of Transaction: 03/01/2016	
CUSTOMER:	
CHARLES R ROBERTS PO BOX 401 YARNELL, AZ 85362-0401 US	

ENTERED
BY: *R Am*

LINE #	QTY	DESCRIPTION	REMARKS	UNIT PRICE	TOTAL
1	1.00	LOCATABLE MINERALS / MINING CLAIMS- NEW, UNADJUD, ONE OR MORE AUTH NOS / NEW MINING CLAIMS LOCATION FEE CASES: AMC437067/\$37.00		- n/a -	37.00
2	1.00	LOCATABLE MINERALS / MINING CLAIMS- NEW, UNADJUD, ONE OR MORE AUTH NOS / NEW MINING CLAIM PROCESSING FEE CASES: AMC437067/\$20.00		- n/a -	20.00
3	1.00	LOCATABLE MINERALS / MINING CLAIMS- NEW, UNADJUD, ONE OR MORE AUTH NOS / NEW MINING CLAIMS MAINTENANCE FEE CASES: AMC437067/\$155.00		- n/a -	155.00
TOTAL:					\$212.00

PAYMENT INFORMATION			
1	AMOUNT:	212.00	POSTMARKED: N/A
	TYPE:	CASH	RECEIVED: 03/01/2016
	NAME:	ROBERTS, CHARLES R PO BOX 401 YARNELL AZ 85362-0401 US	

REMARKS

This receipt was generated by the automated BLM Collections and Billing System and is a paper representation of a portion of the official electronic record contained therein.

NOTICE!!

These documents have been scanned!

Do not place un-scanned documents beneath this notice!

Do not remove this notice from this file!

GPO Jacket No. 560-102
Print Order 61540
Rise Business Services, LLC
Job=AZ15 5/2/2019



Box Number= AZ15019



Claim Begin-End: AMC437067-AMC437067

2 Correspondence



AZ15019-14

AMC436731-AMC437154

AMC. 437067

437067

Old Address:

Charles R. Roberts

401 E. Wickenburg Way

Lot. 3B

Wickenburg AZ 85390

New Address.

Charles R. Roberts

78 S. Kerkos St.

Lot # 17

Wickenburg AZ. 85390

Charles R. Roberts

1-11-18

RECEIVED
PROPERTY OFFICE
2018 JAN 11 A 11:08
PHOENIX, ARIZONA

ENTERED
JAN 11 2018
BY: *RAM*

NOTICE!!

These documents have been scanned!

Do not place un-scanned documents beneath this notice!

Do not remove this notice from this file!

GPO Jacket No. 560-102
Print Order 61540
Rise Business Services, LLC
Job=AZ15 5/2/2019



Box Number= AZ15019



Claim Begin-End: AMC437067-AMC437067

3 Transfers



AZ15019-14

AMC436731-AMC437154

437067

QUIT CLAIM DEED

FOR VALUABLE CONSIDERATION, the sufficiency and receipt of which is hereby acknowledged, Charles R. Roberts does hereby forever quit claim all his right, title and interest in the unpatented mining claims described on the supplemental attachment, attached hereto and incorporated herein by reference, to Claim # 437067.

IN WITNESS WHEREOF, grantor has executed this instrument as of this 17 day of April, 20 19

Charles R. Roberts

Exempt from A.R.S. 11-1133 and 11-1137(B) by A.R.S. 11-1134(A)(6)

STATE OF ARIZONA)
County of Maricopa) ss.

SUBSCRIBED AND SWORN TO before me, a Notary Public, this 17 day of April, 20 19

By: Charles R Roberts

Notary Public [Signature]

My Commission Expires 4-25-2022



Grenatee
ISAAC L. COOK
P.O. Box 658
PAULDEN AZ. 86334

4428573
Form MCF120
Revised July 2014
ER/ TRF

This form is available from the Arizona Geological Survey and may be reproduced.

ENTERED
APR 24 2019
BY: RAM



LOCATION NOTICE FOR PLACER MINING CLAIM

Amendment BLM Serial # _____

NOTICE IS HEREBY GIVEN that the TIN CAN

_____ placer mining claim has been located by

Charles R. Roberts whose current mailing

address is PO BOX 401

YARNELL, AZ. 85362

The general course of this claim is SE SE and it is situated in YAVAPAI

County, Arizona. This claim is 1320 feet in length and 660 feet in width.

20 Total Claim Acreage. This claim runs from the location monument on which this location notice is posted at the SW corner of the claim approximately 660 feet in a NORTH direction to the NW end line and 1320 feet in a EAST direction to the NE end line. This claim is marked by four monuments, one at each corner of the claim.

The location monument on which this notice is posted is situated within Section 7, Township

9 N, Range 4 W, Gila Salt River Base and Meridian, Arizona. This claim encompasses portions of the following legal subdivision(s) if located by legal subdivision or the following quarter section(s),

section(s), Township(s) and Range(s) SESE QUARTER SECTION, SECTION 7 TOWNSHIP 9N, RANGE 4W, Gila Salt River Base and Meridian, Arizona.

The locality of this claim with reference to some natural object or permanent monument and additional information

(if any) concerning its locality are as follows: ABOUT 3/4 MILE IN A SOUTHERNLY DIRECTION FROM OCTAVE MINE

The above information is shown on the attached map.

DATED AND POSTED on the ground this 21 day of FEBRUARY, 2016.

LOCATOR(s) AGENT

Print Name(s) Charles R. Roberts

Signature(s) Charles R. Roberts

Form MCF102
Revised July 2014

Charles R. Roberts

AMC437067

BLM
Date
Stamp

RECEIVED
LM AZ STATE OFFICE
2016 MAR - 1 A 11:05
PHOENIX, ARIZONA

Send to

MINING CLAIM MAP

Lode () Placer
Millsite ()

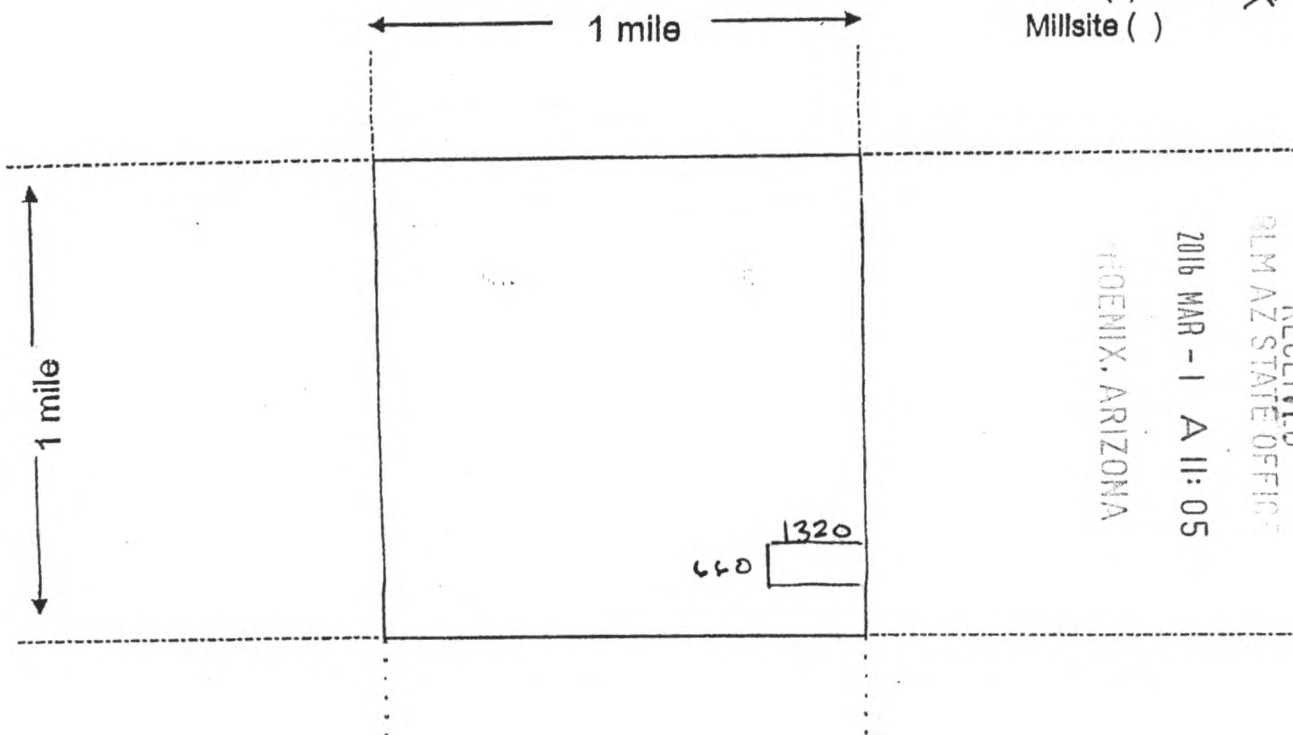

RECEIVED
BLM AZ STATE OFFICE

2016 MAR - 1 A 11: 05

PHOENIX, ARIZONA



Scale: 1" = 2000 feet

1. The above map depicts the TIN CAN mining claim, which is located in Section (s) 7, Township 9 N, Range 4 W, Gila and Salt River Base and Meridian, YAVAPAI County, Arizona. Total claim acreage is 20

2. The type of corner and location monuments used are as follows: METAL POST
4' HIGH MARKET WITH LOCATION AND NAME

3. The bearings and distances in degrees and feet between claim corners and to a public land survey monument are as depicted on the map.

4. If the claim is a placer or millsite claim with exterior limits conforming to legal subdivisions of the public survey, provide a legal description of the claim SE SE QUARTER SECTION, SECTION 7
TOWNSHIP 9N, RANGE 4W

Form MCF100a
Revised July 2014

This form is available from the Arizona Geology Survey and may be reproduced.

AMC437067

United States Department of the Interior
Bureau of Land Management
 DIV OF LANDS, MINRLS & ENERGY
 ONE N CENTRAL AVE
 PHOENIX, AZ 85004 -4427
 Phone: 602-417-9200

Receipt

No: 4428573

Transaction #: 4547785	
Date of Transaction: 04/17/2019	
CUSTOMER:	
CHARLES R ROBERTS 78 S KERKES ST LOW #17 WICKENBURG, AZ 85390-2327 US	

LINE #	QTY	DESCRIPTION	REMARKS	UNIT PRICE	TOTAL
1	1.00	LOCATABLE MINERALS / MINING CLAIMS-NOT NEW-UNADJUD, ONE AUTH NO. ONLY / MINING CLAIM MONEY RECEIVED CASES: AMC437067/\$15.00	TRANSFER (1)	- n/a -	15.00
TOTAL:					\$15.00

PAYMENT INFORMATION					
1	AMOUNT:	15.00	POSTMARKED:	N/A	
	TYPE:	CASH	RECEIVED:	04/17/2019	
	NAME:	ROBERTS, CHARLES R 78 S KERKES ST LOW #17 WICKENBURG AZ 85390-2327 US			

REMARKS

This receipt was generated by the automated BLM Collections and Billing System and is a paper representation of a portion of the official electronic record contained therein.

**NO
DOCUMENTS
FOUND**

NO DOCUMENTS FOUND
NO DOCUMENTS FOUND

NOTICE!!

These documents have been scanned!

Do not place un-scanned documents beneath this notice!

Do not remove this notice from this file!

GPO Jacket No. 560-102
Print Order 61540
Rise Business Services, LLC
Job=AZ15 5/2/2019



Box Number= AZ15019



Claim Begin-End: AMC437067-AMC437067

4 Annual Filings



AZ15019-14

AMC436731-AMC437154

UNITED STATES
DEPARTMENT OF THE INTERIOR
BUREAU OF LAND MANAGEMENT

386

437067

MAINTENANCE FEE WAIVER CERTIFICATION

FORM APPROVED
OMB NO. 1004-0114
Expires: January 31, 2020

SEE INSTRUCTIONS ON PAGE 2

- This small miner waiver is filed for the assessment year beginning on September 1, 2019 and ending on September 1, 2020.
- The undersigned and all related parties owned ten or fewer mining claims, mill, or tunnel sites located and maintained on Federal lands in the United States of America on September 1, 2019.
- The undersigned have performed the assessment work required by law for each mining claim listed prior to filing this waiver and understand that by filing this form, the undersigned must file an affidavit of assessment work with the Bureau of Land Management (BLM) by the December 30th following the filing of this waiver.
- The undersigned understand that if the assessment work obligation has not yet come due under 30 U.S.C. 28 (for those claims in their first assessment year only), a notice of intent to hold reciting this condition must be recorded by the December 30th following the filing of this waiver.
- The undersigned understand that mill and tunnel sites may also be listed on this waiver and be waived from payment of the maintenance fee, and that a notice of intent to hold for these sites is required to be filed with the BLM by the December 30th following the filing of this waiver.
- The undersigned understand and acknowledge that pursuant to 43 U.S.C. 1212 and 18 U.S.C. 1001, the filing or recording of a false, fictitious, or fraudulent document with the BLM may result in a fine of up to \$250,000, a prison term not to exceed five years, or both.
- The mining claims, mill or tunnel sites for which this waiver from payment of the maintenance fees is requested are:

CLAIM OR SITE NAME	BLM RECORDATION SERIAL NUMBER
1. Tin Can	AMC437067
2.	
3.	
4.	
5.	
6.	
7.	
8.	
9.	
10.	

The owner(s) (claimants) of the above mining claims and sites are:

Isaac Cook
(Owner's Name - Please Print)

(Owner's Signature)

PO Box 658
(Owner's Mailing Address)

Paulden AZ 86334
(City) (State) (Zip Code)

(Owner's Name - Please Print)

(Owner's Signature)

(Owner's Mailing Address)

(City) (State) (Zip Code)

(Owner's Name - Please Print)

(Owner's Signature)

(Owner's Mailing Address)

(City) (State) (Zip Code)

(Owner's Name - Please Print)

(Owner's Signature)

(Owner's Mailing Address)

(City) (State) (Zip Code)

(Continued on page 2)

PHOENIX, ARIZONA
2019 AUG 28 P 2:08 PM

RECEIVED
BLM AZ STATE OFFICE

ENTERED
SEP 18 2019
BY: [Signature]

nww

(Owner's Name - Please Print)	(Owner's Signature)
(Owner's Mailing Address)	(City) (State) (Zip Code)
(Owner's Name - Please Print)	(Owner's Signature)
(Owner's Mailing Address)	(City) (State) (Zip Code)
(Owner's Name - Please Print)	(Owner's Signature)
(Owner's Mailing Address)	(City) (State) (Zip Code)
(Owner's Name - Please Print)	(Owner's Signature)
(Owner's Mailing Address)	(City) (State) (Zip Code)

18 U.S.C. 1001 and 43 U.S.C. 1212 make it a crime for any person knowingly and willfully to make to any department or agency of the United States any false, fictitious or fraudulent statements or representations as to any matter within its jurisdiction.

INSTRUCTIONS

1. This certification is made under the provisions of 43 U.S.C. § 1744 and 30 U.S.C. §28-28k and the regulations thereunder (43 CFR Part 3830).
2. The claimant(s) must fill in the dates in paragraph 1 for the beginning and ending of the assessment year for which this waiver is sought.
3. The claimant(s) must fill in the date in paragraph 2 for the beginning of the assessment year for which this waiver is sought.
4. All claim and site names and BLM serial numbers must be listed for the mining claims, mill sites, and tunnel sites for which the waiver is sought.
5. All owners of the mining claims, mill sites, and tunnel sites and their addresses must be given.
6. This waiver form must be signed by all the claimants or their designated agent, in original form. If an agent is designated, a notarized designation of agent, signed by all of the claimants with proper address given, must be submitted with this waiver.
7. This form must be filed no later than September 1st for the upcoming assessment year in the BLM State Office where the mining claims or sites are recorded, or the waiver cannot be granted by the BLM. (Example: To obtain a waiver for the assessment year 2012, which begins on September 1, 2011, you must qualify for and file for a waiver no later than September 1, 2011, in the proper BLM State Office.)
8. For all mining claims which require assessment work, you must record an affidavit of labor on or before the December 30th immediately following the filing of this waiver. For all other mining claims or sites waived, you must record a notice of intent to hold on or before the December 30th immediately following the filing of this waiver.
9. Mill and tunnel sites may also be listed on this waiver and be waived from payment of the maintenance fee. A notice of intent to hold for these sites is required to be filed by the December 30th following the filing of this waiver.

RECEIVED

BLM STATE OFFICE

2011 AUG 28 12:06 PM

PHOENIX, ARIZONA

FOR OFFICIAL USE ONLY

347

ETC 437067

MAINTENANCE FEE WAIVER CERTIFICATION

FORM APPROVED
OMB NO. 1004-0114
Expires: January 31, 2020

SEE INSTRUCTIONS ON PAGE 2

- This small miner waiver is filed for the assessment year beginning on September 1, 2018 and ending on September 1, 2019.
- The undersigned and all related parties owned ten or fewer mining claims, mill, or tunnel sites located and maintained on Federal lands in the United States of America on September 1, 2018.
- The undersigned have performed the assessment work required by law for each mining claim listed prior to filing this waiver and understand that by filing this form, the undersigned must file an affidavit of assessment work with the Bureau of Land Management (BLM) by the December 30th following the filing of this waiver.
- The undersigned understand that if the assessment work obligation has not yet come due under 30 U.S.C. 28 (for those claims in their first assessment year only), a notice of intent to hold reciting this condition must be recorded by the December 30th following the filing of this waiver.
- The undersigned understand that mill and tunnel sites may also be listed on this waiver and be waived from payment of the maintenance fee, and that a notice of intent to hold for these sites is required to be filed with the BLM by the December 30th following the filing of this waiver.
- The undersigned understand and acknowledge that pursuant to 43 U.S.C. 1212 and 18 U.S.C. 1001, the filing or recording of a false, fictitious, or fraudulent document with the BLM may result in a fine of up to \$250,000, a prison term not to exceed five years, or both.
- The mining claims, mill or tunnel sites for which this waiver from payment of the maintenance fees is requested are:

CLAIM OR SITE NAME	BLM RECORDATION SERIAL NUMBER
1. Tin Can	AMC437067 (913)
2.	
3.	
4.	
5.	
6.	
7.	
8.	
9.	
10.	

The owner(s) (claimants) of the above mining claims and sites are:

Charles R. Roberts

Charles R. Roberts

(Owner's Name - Please Print)

(Owner's Signature)

78 South Kirkes St. Lot #17

Wickenburg

AZ

85390

(Owner's Mailing Address)

(City)

(State)

(Zip Code)

(Owner's Name - Please Print)

(Owner's Signature)

(Owner's Mailing Address)

(City)

(State)

(Zip Code)

(Owner's Name - Please Print)

(Owner's Signature)

(Owner's Mailing Address)

(City)

(State)

(Zip Code)

(Owner's Name - Please Print)

(Owner's Signature)

(Owner's Mailing Address)

(City)

(State)

(Zip Code)

(Continued on page 2)

INTERESTED
SEP 10 2018
BY: *PRB*

RECEIVED
BLM AZ STATE OFFICE
2018 AUG 20 9 43
PHOENIX, ARIZONA

When Recorded Return Document
Charles R. Roberts

78 South Kirkes St. Lot #17
Wickenburg, AZ 85390

AMC 437067

Check here if this is a change of address.

Telephone: 928-231-3802

E-mail address:

AFFIDAVIT OF PERFORMANCE OF ANNUAL WORK

1. State of Arizona, County of Yavapai ss:

2. I (Name) Charles R. Roberts

3. Reside at (Address) 78 South Kirkes St. Lot #17

City Wickenburg County Maricopa

State AZ zip 85390 being duly sworn, depose and say that I am a citizen of the United States, more than eighteen years of age, and that all of the facts set forth in this affidavit, subject to the provisions and penalties of 18 U.S.C. 1001 pertaining to the filing of false, fictitious, or fraudulent statements with the United States, are true and correct according to the best of my knowledge, information and belief.

4. Owner's name and address (If not shown in Items 1-3 above).

5. That I am personally acquainted with the mining claim(s). The work and improvements were made by and at the expense of the owner(s) of said claim(s). Said contiguous group of claims, listed on this document, are situated in the

(optional) Mining District; Yavapai County, Arizona.

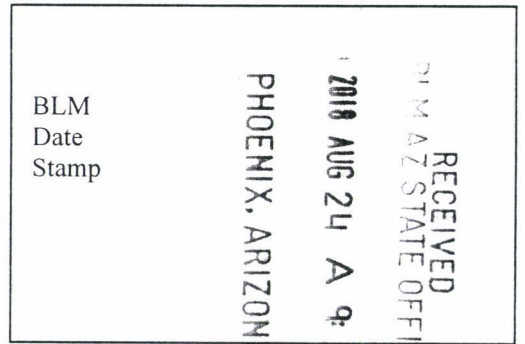

Line No.	AMC NUMBER	CLAIM/SITE NAME	COUNTY RECORDER DATA (If available)	TWP	RNG	SEC
1	437067	Tin Can		9N	4W	7
2						
3						
4						
5						
6						

ENTERED
AUG 30 2018
BY: *[Signature]*

BLM
Date
Stamp

RECEIVED
BLM AZ STATE OFFICE
PHOENIX, ARIZONA
1 2018 AUG 24 A 9:38

7						
8						
9						
10						

6. That between the dates starting at 12 o'clock noon on September 1, 20 17 and ending at 12 o'clock noon on September 1, 20 18 at least \$ 325.00 dollars worth of work and improvements were done and performed upon said claim(s) or upon one or more of a contiguous group of claims for the benefit of all, wholly or partly outside of a contiguous group of claims for the benefit of all, not including the location work.

7. That the following persons were employed to perform the work and improvements described herein: _____
Charles R. Roberts

8. That the work and improvements performed were: Reclamation, Signs, Post, Dead Brush Removal and Road Maintenance.

9. Dated: 8-3-18 Signature: Charles R. Roberts

SUBSCRIBED AND SWORN TO before me, a Notary Public, this 03 day of August 20 18

By: Charles R. Roberts
 Notary Public [Signature]

My Commission Expires 03-29-2022

Bureau of Land Management
 Arizona State Office
www.blm.gov/az

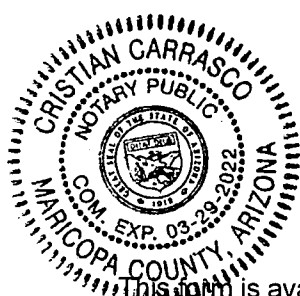

No. of Claims: 1 x \$10 = 10
 Check No.: _____ Init. PER
 Receipt No.: 4243437
 For BLM Use Only

United States Department of the Interior
Bureau of Land Management
 DIV OF LANDS, MINRLS & ENERGY
 ONE N CENTRAL AVE
 PHOENIX, AZ 85004 -4427
 Phone: 602-417-9200

Receipt

No: 4243437

Transaction #: 4358874	
Date of Transaction: 08/24/2018	
CUSTOMER:	
CHARLES R ROBERTS 78 S KERKES ST LOW #17 WICKENBURG, AZ 85390-2327 US	

LINE #	QTY	DESCRIPTION	REMARKS	UNIT PRICE	TOTAL
1	1.00	LOCATABLE MINERALS / MINING CLAIMS-NOT NEW-UNADJUD, ONE AUTH NO. ONLY / MINING CLAIM MONEY RECEIVED CASES: AMC437067/\$10.00	2018 POL AND WAIVER/1	- n/a -	10.00
TOTAL:					\$10.00

PAYMENT INFORMATION			
1	AMOUNT:	10.00	POSTMARKED: N/A
	TYPE:	CASH	RECEIVED: 08/24/2018
	NAME:	ROBERTS, CHARLES R 78 S KERKES ST LOW #17 WICKENBURG AZ 85390-2327 US	

REMARKS

This receipt was generated by the automated BLM Collections and Billing System and is a paper representation of a portion of the official electronic record contained therein.

UNITED STATES
DEPARTMENT OF THE INTERIOR
BUREAU OF LAND MANAGEMENT
MAINTENANCE FEE WAIVER CERTIFICATION

62

AMC 437067

FORM APPROVED
OMB NO. 1004-0114
Expires: January 31, 2020

SEE INSTRUCTIONS ON PAGE 2

- This small miner waiver is filed for the assessment year beginning on September 1, 2017 and ending on September 1, 2018.
- The undersigned and all related parties owned ten or fewer mining claims, mill, or tunnel sites located and maintained on Federal lands in the United States of America on September 1, 2017.
- The undersigned have performed the assessment work required by law for each mining claim listed prior to filing this waiver and understand that by filing this form, the undersigned must file an affidavit of assessment work with the Bureau of Land Management (BLM) by the December 30th following the filing of this waiver.
- The undersigned understand that if the assessment work obligation has not yet come due under 30 U.S.C. 28 (for those claims in their first assessment year only), a notice of intent to hold reciting this condition must be recorded by the December 30th following the filing of this waiver.
- The undersigned understand that mill and tunnel sites may also be listed on this waiver and be waived from payment of the maintenance fee, and that a notice of intent to hold for these sites is required to be filed with the BLM by the December 30th following the filing of this waiver.
- The undersigned understand and acknowledge that pursuant to 43 U.S.C. 1212 and 18 U.S.C. 1001, the filing or recording of a false, fictitious, or fraudulent document with the BLM may result in a fine of up to \$250,000, a prison term not to exceed five years, or both.
- The mining claims, mill or tunnel sites for which this waiver from payment of the maintenance fees is requested are:

CLAIM OR SITE NAME	BLM RECORDATION SERIAL NUMBER
1. <u>TIN CAN</u>	<u>AMC 437067</u>
2.	
3.	
4.	
5.	
6.	
7.	
8.	
9.	
10.	

The owner(s) (claimants) of the above mining claims and sites are:

CHARLES R. ROBERTS ✓ *Charles R. Roberts*
 (Owner's Name - Please Print) (Owner's Signature)

401 E. WICKENBURG WAY lot 3B WICKENBURG AZ. 85390
 (Owner's Mailing Address) (City) (State) (Zip Code)

AC 483
ENTERED SEP 01 2017
PB

(Owner's Name - Please Print) (Owner's Signature)

(Owner's Mailing Address) (City) (State) (Zip Code)

PHOENIX, ARIZONA

(Owner's Name - Please Print) (Owner's Signature)

(Owner's Mailing Address) (City) (State) (Zip Code)

RECEIVED BLM AZ STATE OFFICE
2017 JUL 11 A 9:39

(Owner's Name - Please Print) (Owner's Signature)

(Owner's Mailing Address) (City) (State) (Zip Code)

(Continued on page 2)

NW check
1 ct

(Owner's Name - Please Print)	(Owner's Signature)
(Owner's Mailing Address)	(City) (State) (Zip Code)
(Owner's Name - Please Print)	(Owner's Signature)
(Owner's Mailing Address)	(City) (State) (Zip Code)
(Owner's Name - Please Print)	(Owner's Signature)
(Owner's Mailing Address)	(City) (State) (Zip Code)
(Owner's Name - Please Print)	(Owner's Signature)
(Owner's Mailing Address)	(City) (State) (Zip Code)

18 U.S.C. 1001 and 43 U.S.C. 1212 make it a crime for any person knowingly and willfully to make to any department or agency of the United States any false, fictitious or fraudulent statements or representations as to any matter within its jurisdiction.

INSTRUCTIONS

1. This certification is made under the provisions of 43 U.S.C. § 1744 and 30 U.S.C. §28-28k and the regulations thereunder (43 CFR Part 3830).
2. The claimant(s) must fill in the dates in paragraph 1 for the beginning and ending of the assessment year for which this waiver is sought.
3. The claimant(s) must fill in the date in paragraph 2 for the beginning of the assessment year for which this waiver is sought.
4. All claim and site names and BLM serial numbers must be listed for the mining claims, mill sites, and tunnel sites for which the waiver is sought.
5. All owners of the mining claims, mill sites, and tunnel sites and their addresses must be given.
6. This waiver form must be signed by all the claimants or their designated agent, in original form. If an agent is designated, a notarized designation of agent, signed by all of the claimants with proper address given, must be submitted with this waiver.
7. This form must be filed no later than September 1st for the upcoming assessment year in the BLM State Office where the mining claims or sites are recorded, or the waiver cannot be granted by the BLM. (Example: To obtain a waiver for the assessment year 2012, which begins on September 1, 2011, you must qualify for and file for a waiver no later than September 1, 2011, in the proper BLM State Office.)
8. For all mining claims which require assessment work, you must record an affidavit of labor on or before the December 30th immediately following the filing of this waiver. For all other mining claims or sites waived, you must record a notice of intent to hold on or before the December 30th immediately following the filing of this waiver.
9. Mill and tunnel sites may also be listed on this waiver and be waived from payment of the maintenance fee. A notice of intent to hold for these sites is required to be filed by the December 30th following the filing of this waiver.

PHOENIX, ARIZONA
 11 09 39
 BLM AZ STATE OFFICE
 RECEIVED
 2017 JUL 11
 FOR OFFICIAL USE ONLY

UNITED STATES DEPARTMENT OF THE INTERIOR
BUREAU OF LAND MANAGEMENT

MC NATIONWIDE CLAIMANT LISTING
September 06, 2017

Cust	AZ	National
	CLAIMANT	Total
ROBERTS CHARLES R 401 E WICKENBURG WAY LOT 3B WICKENBURG, AZ 85390-3395	1	1

437067

When Recorded Return Document to:
Charles R. Roberts
401 E. Wickenburg Way
Lot 3 B
Wickenburg Az. 85390

Check here is this is a change of address.

Telephone: _____

E-mail address: _____

AFFIDAVIT OF PERFORMANCE OF ANNUAL WORK

1. State of Arizona, County of YAVAPAI ss:

2. I (Name) CHARLES R. ROBERTS

3. Reside at (Address) 401 E. WICKENBURG WAY
Lot 3 B

City WICKENBURG County MARICOPA

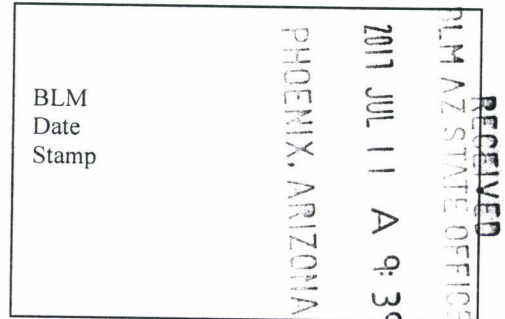

State Az Zip 85390 being duly sworn, depose and say that I am a citizen of the United States, more than eighteen years of age, and that all of the facts set forth in this affidavit, subject to the provisions and penalties of 18 U.S.C. 1001 pertaining to the filing of false, fictitious, or fraudulent statements with the United States, are true and correct according to the best of my knowledge, information and belief.

4. Owner's name and address (If not shown in Items 1-3 above), _____

5. That I am personally acquainted with the mining claim(s). The work and improvements were made by and at the expense of the owner(s) of said claim(s). Said contiguous group of claims, listed on this document, are situated in the

_____ (optional) Mining District; _____ County, Arizona.

Line No.	AMC NUMBER	CLAIM/SITE NAME	COUNTY RECORDER DATA (If available)	TWP	RNG	SEC
1	437067	TIN CAN		9N	4W	7
2						
3						
4						
5						
6						

Form: MCF108
Revised July 2014
Page 1 of 2

ENTERED
JUL 12 2017
BY: RAM

RECEIVED
BLM AZ STATE OFFICE

2017 JUL 11 A 9:39
PHOENIX, ARIZONA

BLM
Date
Stamp

7						
8						
9						
10						

6. That between the dates starting at 12 o'clock noon on September 1, 20 16 and ending at 12 o'clock noon on September 1, 20 17 at least \$ 215.00 dollars worth of work and improvements were done and performed upon said claim(s) or upon one or more of a contiguous group of claims for the benefit of all, wholly or partly outside of a contiguous group of claims for the benefit of all, not including the location work.

7. That the following persons were employed to perform the work and improvements described herein: Charles R. Roberts

8. That the work and improvements performed were: Reclamation, Signs, Posts, Dead BRUSH Removal and ROAD MAINTENANCE

9. Dated: 6-16-17 Signature: Charles R. Roberts

SUBSCRIBED AND SWORN TO before me, a Notary Public, this 16 day of June 20 17

By: Charles R. Roberts

Notary Public Cathy Hinzberg

My Commission Expires FEB 08, 2019

Bureau of Land Management
Arizona State Office
www.blm.gov/az



No. of Claims: 1 x \$10 = \$10.00
 Check No.: cash Init. CR
 Receipt No.: 3884613
 For BLM Use Only

Form: MCF108
Revised July 2014
Page 2 of 2

JUN 21 2017

United States Department of the Interior
Bureau of Land Management
 DIV OF LANDS, MINRLS & ENERGY
 ONE N CENTRAL AVE
 PHOENIX, AZ 85004 -4427
 Phone: 602-417-9200

Receipt

No: 3884613

Transaction #: 3993798	
Date of Transaction: 07/11/2017	
CUSTOMER:	
CHARLES R ROBERTS 401 E WICKENBURG WAY WICKENBURG, AZ 85390-2539 US	

LINE #	QTY	DESCRIPTION	REMARKS	UNIT PRICE	TOTAL
1	1.00	LOCATABLE MINERALS / MINING CLAIMS- NOT NEW-UNADJUD, ONE AUTH NO. ONLY / MINING CLAIM MONEY RECEIVED CASES: AMC437067/\$10.00	2017 POL & 2018 WAIV (1)	- n/a -	10.00
TOTAL:					\$10.00

PAYMENT INFORMATION				
1	AMOUNT:	10.00	POSTMARKED:	N/A
	TYPE:	CASH	RECEIVED:	07/11/2017
	NAME:	ROBERTS, CHARLES R 401 E WICKENBURG WAY WICKENBURG AZ 85390-2539 US		

REMARKS

This receipt was generated by the automated BLM Collections and Billing System and is a paper representation of a portion of the official electronic record contained therein.

437067

MAINTENANCE FEE PAYMENT

Claimant Name: Charles R. Roberts
Address: PO Box 401
City: Yarnell State: AZ Zip: 85362
Telephone: 928-231-5802
E-mail address: _____
Signature: Charles R. Roberts

RECEIVED
BLM AZ STATE OFFICE
2016 AUG 23 A 9:46
PHOENIX, ARIZONA
BLM
Date
Stamp

Check here if this is a change of address.

LINE NO.	AMC NUMBER	CLAIM/SITE NAME	COUNTY RECORDER DATA (If available)	TWP	RNG	SEC
1	AMC 437067	TIN CAN				
2						
3						
4						
5						
6						
7						
8						
9						
10						

List additional claims on Form MCF114.

**Bureau of Land Management
Arizona State Office**
www.blm.gov/az/

No. of Claims*: 1 x \$155 = 155.00
Check No: CASH Init. PER
Receipt No.: 3638053
For BLM Use Only

* \$155 per lode mining claim, mill site, or tunnel site; and \$155 for each 20 acres or portion thereof for each placer mining claim.

Form: MCF112
Revised July 2014

ENTERED
AUG 24 2016
BY: RE

This form is available from the **Arizona Geological Survey** and may be reproduced.

**DEPARTMENT OF THE INTERIOR
BUREAU OF LAND MANAGEMENT
MINING CLAIMS
(MASS) Serial Register Page**

RunDate/Time: 08/23/16 10:45 AM

Page: 1 of 1

01 10-21-1976;090STAT0090;43USC1744
Case Type 384201: PLACER CLAIM
Commodity:
Claim Name: TIN CAN
Case Disposition: ACTIVE
Required Maintenance Fee: \$155.00

Total Acres
20.000

Serial Number
AMC437067
Lead File Number
AMC437067

Name & Address

ROBERTS CHARLES R

PO BOX 401

YARNELL, AZ 85362-0401

Int Rel

CLAIMANT

County/State

YAVAPAI County, AZ

District

PHOENIX DO

Mer Twp Rng Sec Subdivision

14 0090N 0040W 007 SE

<u>Act Date</u>	<u>Code</u>	<u>Action Text</u>	<u>Action Remarks</u>	<u>Receipt Number</u>
02/21/2016	403	LOCATION DATE		
03/01/2016	395	RECORDATION NOTICE RECD	1	3505454
03/01/2016	484	LOCATION YEAR / MAINTENAN	2016;\$155	3505454
07/21/2016	669	LAND STATUS CHECKED		
03/01/2016	501	ACCT ADV IN LEAD FILE	AMC437067;	

Line Nr Remarks

United States Department of the Interior
Bureau of Land Management
 DIV OF LANDS, MINRLS & ENERGY
 ONE N CENTRAL AVE
 PHOENIX, AZ 85004 -4427
 Phone: 602-417-9200

Receipt

No: 3638053

Transaction #: 3741943	
Date of Transaction: 08/23/2016	
CUSTOMER:	
CHARLES R ROBERTS PO BOX 401 YARNELL, AZ 85362-0401 US	

LINE #	QTY	DESCRIPTION	REMARKS	UNIT PRICE	TOTAL
1	1.00	LOCATABLE MINERALS / MINING CLAIMS- NOT NEW-UNADJUD, ONE AUTH NO. ONLY / MINING CLAIM MONEY RECEIVED CASES: AMC437067/\$155.00	2017 MAINT/1	- n/a -	155.00
TOTAL:					\$155.00

PAYMENT INFORMATION			
1	AMOUNT:	155.00	POSTMARKED: N/A
	TYPE:	CASH	RECEIVED: 08/23/2016
	NAME:	ROBERTS, CHARLES R PO BOX 401 YARNELL AZ 85362-0401 US	

REMARKS

This receipt was generated by the automated BLM Collections and Billing System and is a paper representation of a portion of the official electronic record contained therein.

NOTICE!!

These documents have been scanned!

Do not place un-scanned documents beneath this notice!

Do not remove this notice from this file!

GPO Jacket No. 560-102
Print Order 61540
Rise Business Services, LLC
Job=AZ15 5/2/2019



Box Number= AZ15019



Claim Begin-End: AMC437067-AMC437067

5 Miscellaneous



AZ15019-14

AMC436731-AMC437154

437067

*Address change only

MAINTENANCE FEE PAYMENT

Claimant Name: Charles R. Roberts
Address: 401 E Wickenburg Way Lot 3B
City: Wickenburg State: AZ Zip: 85390
Telephone: 928 - 231-3802
E-mail address: _____
Signature: [Signature]

RECEIVED
BLM AZ STATE OFFICE
2017 FEB - 3 A 10: 35
PHOENIX, ARIZONA
BLM
Date
Stamp

Check here if this is a change of address.

LINE NO.	AMC NUMBER	CLAIM/SITE NAME	COUNTY RECORDER DATA (If available)	TWP	RNG	SEC
1	AMC 437067					
2						
3						
4						
5						
6						
7						
8						
9						
10						

List additional claims on Form MCF114.

No. of Claims*: _____ x \$155 = _____
 Check No: _____ Init. _____
 Receipt No.: _____
 For BLM Use Only

Bureau of Land Management
Arizona State Office
www.blm.gov/az/

* \$155 per lode mining claim, mill site, or tunnel site; and \$155 for each 20 acres or portion thereof for each placer mining claim.

Form: MCF112
Revised July 2014

This form is available from the Arizona Geological Survey and may be reproduced.

ENTERED
FEB 03 2017
BY: KAM

NOTICE!!

These documents have been scanned!

Do not place un-scanned documents beneath this notice!

Do not remove this notice from this file!

GPO Jacket No. 560-102
Print Order 61540
Rise Business Services, LLC
Job=AZ15 5/2/2019



Box Number= AZ15019



Claim Begin-End: AMC437067-AMC437067

6 Location Notices-Amendments and Supporting Documents



AZ15019-14

AMC436731-AMC437154

MINING CLAIM STATUS REPORT

Data Entered: 03/03/16 Rmn

MTP Checked By: 03/03/16 Rmn
GEO Checked By: 03/03/16 Rmn

LEAD SERIAL NUMBER: AMC 437067 thru AMC _____

NUMBER OF CLAIMS & TYPE:

- LODE
- PLACER
- ASSOCIATION PLACER
- MILL SITE
- TUNNEL SITE

CHARGES:

Location Fee @ \$37 = \$ 37

Processing Fee @ \$20 = \$ 20

Maintenance Fee @ \$155 = \$ 155

Add'l Maint Fee for Assoc Placer = \$ _____

SUBTOTAL \$ 212

Other Fees \$ _____

Other Fees \$ _____

TOTAL \$ 212

TOTAL ACREAGE: 20 Per Claim
(Placer Only)

NUMBER OF LOCATORS: 1

DOCUMENTS RECEIVED VIA : Over-the-Counter Mail TIMELY FILED: Yes No

LEGAL DESCRIPTION: T 9N R 4W SEC 7

T _____ R _____ SEC _____

T _____ R _____ SEC _____

T _____ R _____ SEC _____

T _____ R _____ SEC _____

BLM FOREST SERVICE SUBJ TO PL 359: Yes No
WILDERNESS AREA

SPLIT ESTATE: N/A SX PX OTHER
SRHA Was proper Notice filed if located on SHRA Land? Yes No

RECONVEYED MINERALS ON BLM LAND REQUIRE OPENING ORDER FROM 1944 TO 1993:

Open to Entry On _____ N/A

COMMENTS/STATUS: VOID PARTIALLY VOID PVT MINERALS WITHDRAWN LANDS
OTHER LLD N/2 SE6E SEC 7, USED MAP FOR COMPLETE LLD-

AMC437067

Claimant acknowledges that portions of the following claim(s) site(s) may be void or voidable.

Printed Name of Claimant _____ Signature of Claimant _____

*****FINAL ADJUDICATION*****

DATE 7/21/2016 INITIALS Rmn

LOCATION NOTICE FOR PLACER MINING CLAIM

Amendment BLM Serial # _____

NOTICE IS HEREBY GIVEN that the TIN CAN

_____ placer mining claim has been located by
Charles R. Roberts whose current mailing
address is PO Box 401
YARNELL, AZ. 85362

BLM
Date
Stamp

RECEIVED
LM AZ STATE OFFICE
2016 MAR - 1 A 11:05
PHOENIX, ARIZONA

The general course of this claim is SE SE and it is situated in YAVAPAI
County, Arizona. This claim is 1320 feet in length and 660 feet in width.

20 Total Claim Acreage. This claim runs from the location monument on which this location notice is
posted at the SW corner of the claim approximately 660 feet in a NORTH direction to the
NW end line and 1320 feet in a EAST direction to the NE end line. This claim is
marked by four monuments, one at each corner of the claim.

The location monument on which this notice is posted is situated within Section 7, Township
9 N, Range 4 W, Gila Salt River Base and Meridian, Arizona. This claim encompasses
portions of the following legal subdivision(s) if located by legal subdivision or the following quarter section(s),
section(s), Township(s) and Range(s) SESE QUARTER SECTION, SECTION 7
TOWNSHIP 9N, RANGE 4W, Gila Salt River Base and Meridian, Arizona.

The locality of this claim with reference to some natural object or permanent monument and additional information
(if any) concerning its locality are as follows: ABOUT 3/4 MILE IN A
SOUTHERNLY DIRECTION FROM OCTAVE MINE

_____ The above information is shown on the attached map.

DATED AND POSTED on the ground this 21 day of FEBRUARY, 2016.

LOCATOR(s) AGENT

Print Name(s) Charles R. Roberts

Signature(s) Charles R. Roberts

Form MCF102
Revised July 2014

AMC437067

MINING CLAIM MAP

Lode () Placer
 Millsite ()

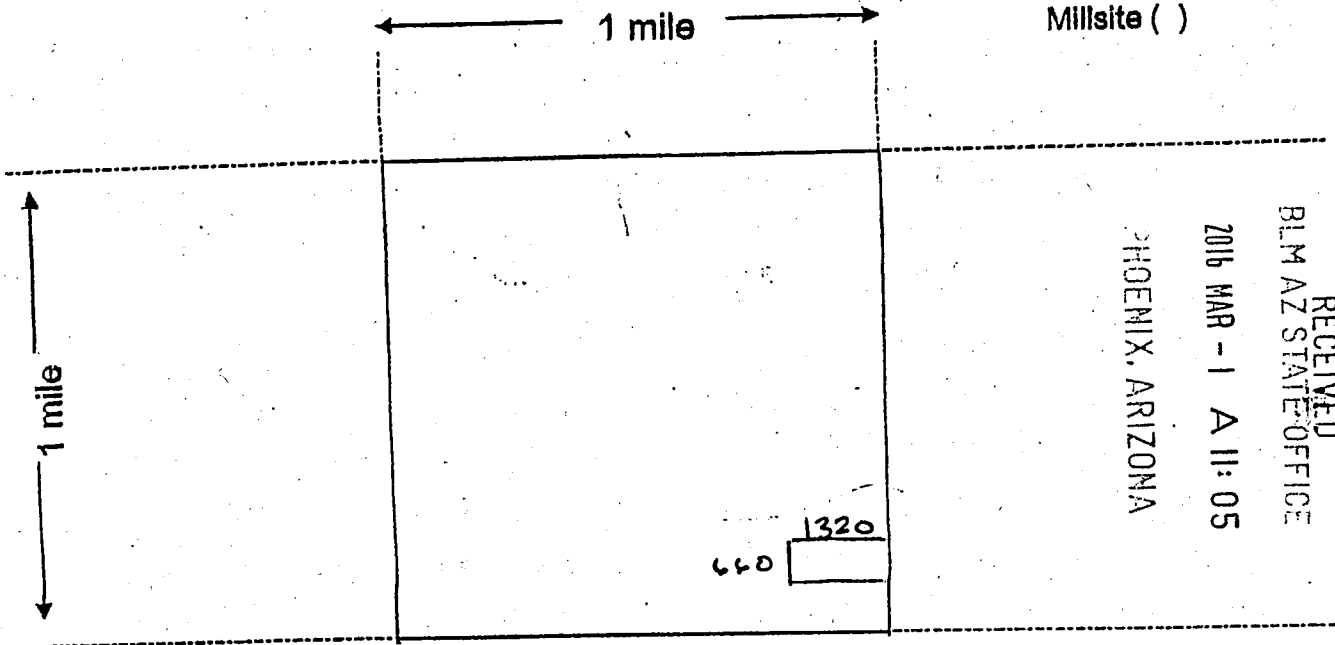

RECEIVED
 BLM AZ STATE OFFICE
 2016 MAR - 1 A 11:05
 PHOENIX, ARIZONA

Scale: 1" = 2000 feet



- The above map depicts the TIN CAN mining claim, which is located in Section (s) 7, Township 9 N, Range 4 W, Gila and Salt River Base and Meridian, YAVAPAI County, Arizona. Total claim acreage is 20.
- The type of corner and location monuments used are as follows: METAL POST
4' HIGH MARKER WITH LOCATION AND NAME
- The bearings and distances in degrees and feet between claim corners and to a public land survey monument are as depicted on the map.
- If the claim is a placer or millsite claim with exterior limits conforming to legal subdivisions of the public survey, provide a legal description of the claim SE SE QUARTER SECTION 7
TOWNSHIP 9N, RANGE 4W

Form MCF100a
 Revised July 2014

This form is available from the Arizona Geology Survey and may be reproduced.

AMC4370671

DEPARTMENT OF INTERIOR
BUREAU OF LAND MANAGEMENT

Input Parameters for Geographic Report with Land

System Id = CR

Admin State = AZ

Geo State =

Casetype Begins With

Case Disp Txt = AUTHORIZED, CANCELLED, EXPIRED, PENDING, REJECTED, RELINQUISHED, VOID, WITHDRAWN

Mer Twp Rng = 14 0090N 0040W

Section = 007, 999

Mtrs =

Commodity =

Commodity Txt =

Pending Org =

Pend Org Decode =

Total Rows Returned: 8

RUN TIME: 11:01 AM

UNITED STATES DEPARTMENT OF INTERIOR
BUREAU OF LAND MANAGEMENT
GEOGRAPHIC REPORT WITH LAND
Sorted by Meridian Township Range

RUN DATE: 03/01/2016
Page 1 of 2

Adm State: AZ

Serial Number: AZA 029027

Total Case Acres: 1.000

<u>Casetype</u>	<u>Case Disp</u>				<u>Sect</u>	<u>Sur Typ</u>	<u>Sur Num</u>	<u>Suff</u>	<u>Subdivision</u>	<u>Act Pend</u>
380913	EXPIRED	14	0090N	0040W	007	ALIQ			ALL;	

Serial Number: AZA 031568

Total Case Acres: 1.000

<u>Casetype</u>	<u>Case Disp</u>				<u>Sect</u>	<u>Sur Typ</u>	<u>Sur Num</u>	<u>Suff</u>	<u>Subdivision</u>	<u>Act Pend</u>
293200	EXPIRED	14	0090N	0040W	007	FF			PORTION OF;	

Serial Number: AZA 033132

Total Case Acres: 5.000

<u>Casetype</u>	<u>Case Disp</u>				<u>Sect</u>	<u>Sur Typ</u>	<u>Sur Num</u>	<u>Suff</u>	<u>Subdivision</u>	<u>Act Pend</u>
380913	AUTHORIZED	14	0090N	0040W	007	ALIQ			NE;	

Serial Number: AZA 033132O

Total Case Acres: 5.000

<u>Casetype</u>	<u>Case Disp</u>				<u>Sect</u>	<u>Sur Typ</u>	<u>Sur Num</u>	<u>Suff</u>	<u>Subdivision</u>	<u>Act Pend</u>
371511	AUTHORIZED	14	0090N	0040W	007	FF			NE;	

Serial Number: AZA 035690

Total Case Acres: 0.065

<u>Casetype</u>	<u>Case Disp</u>				<u>Sect</u>	<u>Sur Typ</u>	<u>Sur Num</u>	<u>Suff</u>	<u>Subdivision</u>	<u>Act Pend</u>
285003	AUTHORIZED	14	0090N	0040W	007	ALIQ			NWNE;	

RUN TIME: 11:01 AM

UNITED STATES DEPARTMENT OF INTERIOR
BUREAU OF LAND MANAGEMENT
GEOGRAPHIC REPORT WITH LAND
Sorted by Meridian Township Range

RUN DATE: 03/01/2016
Page 2 of 2

Serial Number: AZA 035884

Total Case Acres: 1.000

<u>Casetype</u>	<u>Case Disp</u>			<u>Sect</u>	<u>Sur Typ</u>	<u>Sur Num</u>	<u>Suff</u>	<u>Subdivision</u>	<u>Act Pend</u>
380913	AUTHORIZED	14	0090N	0040W	007	ALIQ		NWNE;	Y

Serial Number: AZA 036890

Total Case Acres: 1.500

<u>Casetype</u>	<u>Case Disp</u>			<u>Sect</u>	<u>Sur Typ</u>	<u>Sur Num</u>	<u>Suff</u>	<u>Subdivision</u>	<u>Act Pend</u>
380910	PENDING	14	0090N	0040W	007	FF		SW;	

Serial Number: AZAR 0000110

Total Case Acres: 39.400

<u>Casetype</u>	<u>Case Disp</u>			<u>Sect</u>	<u>Sur Typ</u>	<u>Sur Num</u>	<u>Suff</u>	<u>Subdivision</u>	<u>Act Pend</u>
285003	AUTHORIZED	14	0090N	0040W	007	ALIQ LOTS		W2E2; 2,3,4;	